

How to Install the UV Clarifier

Fitting your Pond Clear Advantage unit could not be easier. The unit is connected into the water circulation system as shown below and connected to a mains electricity supply in the same way as fitting a plug. Full instructions are enclosed with each unit.

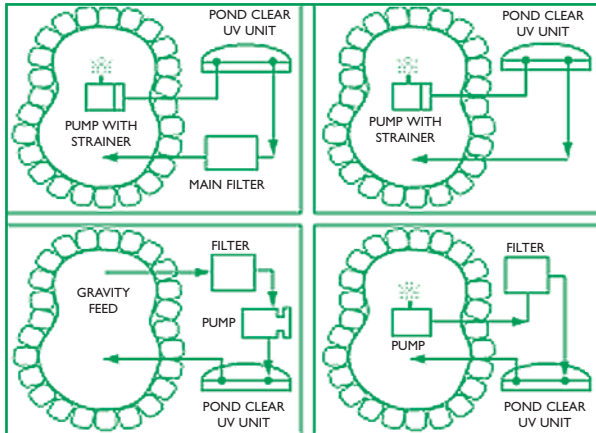

What Size Unit ?

The main factors which govern the model you will need are pond size, flow rate, stocking level and the amount of sunlight the pond is subject to. Use the table below to select the correct model for your pond. If in doubt ask your dealer or telephone the Technical Advice number overleaf.

WHICH MODEL?	☀️		☀️		☀️	
	☰	☰	☰	☰	☰	☰
☑️ < 400 UK GALLONS < 1800 LITRES	POND CI FAR UV6	POND CI FAR UV6	POND CI FAR UV6	POND CI FAR UV6	POND CI FAR UV6	POND CI FAR UV6
☑️ < 600 UK GALLONS < 2700 LITRES	POND CI FAR UV6	POND CI FAR UV8	POND CI FAR UV8	POND CI FAR UV8	POND CI FAR UV8	POND CI FAR UV8
☑️ < 1200 UK GALLONS < 5400 LITRES	POND CLEAR UV8	POND CI FAR UV15	POND CI FAR UV8	POND CI FAR UV15	POND CI FAR UV15	POND CI FAR UV15
☑️ < 1500 UK GALLONS < 6750 LITRES	POND CI FAR UV15	POND CI FAR UV15	POND CI FAR UV15	POND CI FAR UV15	POND CI FAR UV15	POND CI FAR UV25
☑️ < 3000 UK GALLONS < 13500 LITRES	POND CI FAR UV15	POND CI FAR UV25	POND CI FAR UV15	POND CI FAR UV25	POND CI FAR UV25	POND CI FAR UV30
☑️ < 4000 UK GALLONS < 18000 LITRES	POND CI FAR UV25	POND CI FAR UV30	POND CI FAR UV30	POND CI FAR UV30	POND CI FAR UV30	POND CI FAR UV55
☑️ < 6000 UK GALLONS < 27000 LITRES	PRO CI FAR UV30	PRO CI FAR UV55	PRO CI FAR UV55	PRO CI FAR UV55	PRO CI FAR UV55	PRO CI FAR UV55
☑️ < 10000 UK GALLONS < 45000 LITRES	PRO CLEAR UV55	PRO CLEAR UV55	PRO CLEAR UV55	7% PRO CLEAR UV55	PRO CLEAR UV55	7% PRO CLEAR UV55

Free Technical Advice

As a service to our customers, TMC offers free technical advice on all Pond Clear Advantage products.

Simply call 01923 284151 between 9am and 5pm Monday to Thursday, and between 9am and 2pm on Fridays.

The Reliable Aquatics Supplier

TMC has been established since 1970 and pioneered the development of ultraviolet water clarifying equipment. Pond Clear Advantage products are designed for reliability and a long working life. Spare parts and replacement lamps are always readily available.



Tropical Marine Centre
 Solesbridge Lane, Chorleywood, Herts WD3 5SX
 Tel: +44 (0)1923 284151 Fax: +44 (0)1923 285840

Tropical Marine Centre
 Unit 2, Cribbs Causeway Centre, The Laurels, Bristol BS10 7TT
 Tel: +44 (0)117 9581150 Fax: +44 (0)117 9581152

Tropical Marine Centre
 Unit 3, Beta Court, Harper Road, Manchester M22 4QE
 Tel: +44 (0)161 9461538 Fax: +44 (0)161 9989599

Email: tmc@tmc-ltd.co.uk
 Websites: www.tmc-ltd.co.uk www.tmc-publishing.com

Pond Clear Advantage

Ultraviolet Pond Clarifiers



GUARANTEES CLEAR WATER

If installed in accordance with the manufacturer's instructions and the unit is the correct size for the pond capacity, pump size, stock level and situation

How do they work?

At the heart of each unit is an ultraviolet lamp housed within a quartz sleeve. As water is constantly pumped from the pond through the unit, the UV emitted from the lamp destroys the single-celled algae which causes the pond water to turn green. With constant use the pond water will remain crystal clear.

1. Green water enters unit
2. Water is treated by UV light
3. Treated water returns to pond
4. Multi-stage, translucent hoses show that UV lamp is working
5. UV shield
6. Quartz sleeve
7. High power UV lamp

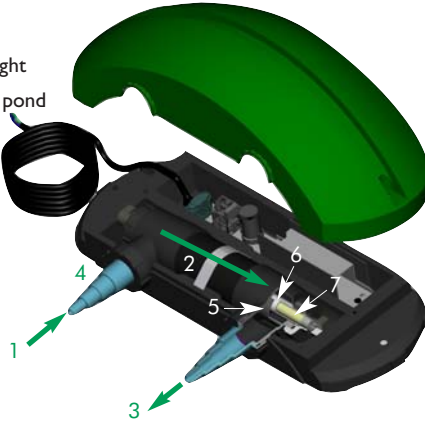

UV Clarifiers - The Benefits

Clear Water



- No adverse effect on sensitive plant and pond life.
- As no chemicals or other environmentally harmful processes are used, there is no danger of pollution or over-treatment of the water.

Clear Water

Pond Clear Advantage ^{CE}

Easy to Install



Easy to Use



Easy to Maintain



Features

- Robust construction and new ergonomic, green and black design.
 - Surface, filter or wall mountable and supplied with a wall mounting kit and a filter lid fixing kit.
 - Four-stage hoses designed to take flexible hose from 1/2" to 1 1/4". Hoses are held in place with screw on collars, allowing the disconnection of the hose, leaving the unit or the hose in situ for ease of servicing and maintenance.
 - Rigid pipe adaptors, for connection to 40mm solvent weld rigid pipe, are included with the unit. These adaptors are held in place with screw on collars, allowing the disconnection of the rigid pipe, leaving the unit or the rigid pipe in situ for ease of servicing and maintenance.
 - Easy access to working parts making maintenance quick and easy.
 - Supplied with a 5 metre power cable.
 - Complete with comprehensive instructions and backed up with full technical support from TMC.
 - Full 36 month guarantee against any defect or failure. This covers all parts and labour.
- This unit is manufactured and conforms to BS EN 60335-1 and BS EN 60335-2-55.*
- This unit conforms to the low voltage directive (safety) CEE 73 23.*
- This unit conforms to the EMC directive CEE 89 336.*
- This unit is CE approved.*



Units Available

UV8 - Suitable for ponds up to 1200 UK Gal (5400 litres/ 1440 US Gal) with a maximum flow rate of 600 UK Gal (2700 litres/720 US Gal) per hour

UV15 - Suitable for ponds up to 3000 UK Gal (13500 litres/ 3600 US Gal) with a maximum flow rate of 1500 UK Gal (6750 litres/1800 US Gal) per hour

UV25 - Suitable for ponds up to 4000 UK Gal (18000 litres/ 4800 US Gal) with a maximum flow rate of 2000 UK Gal (9000 litres/2400 US Gal) per hour

• No Chemicals

• No Fuss